

High Power Fiber Coupled Diode Laser

E7 Series

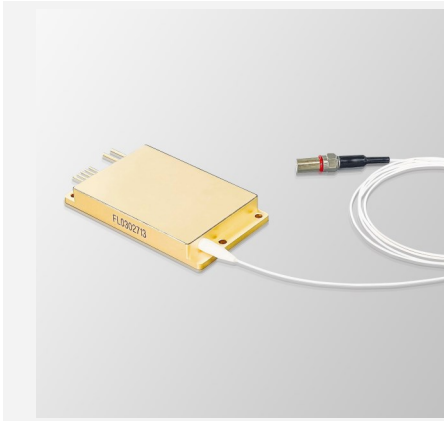

Features

- High brightness
- High power
- Compact housing
- Hermetically sealed housing
- Conduction Cooling

Applications

- Advanced Manufacturing
- Health
- Information Technology
- Scientific Research

Product Dimensions (mm)

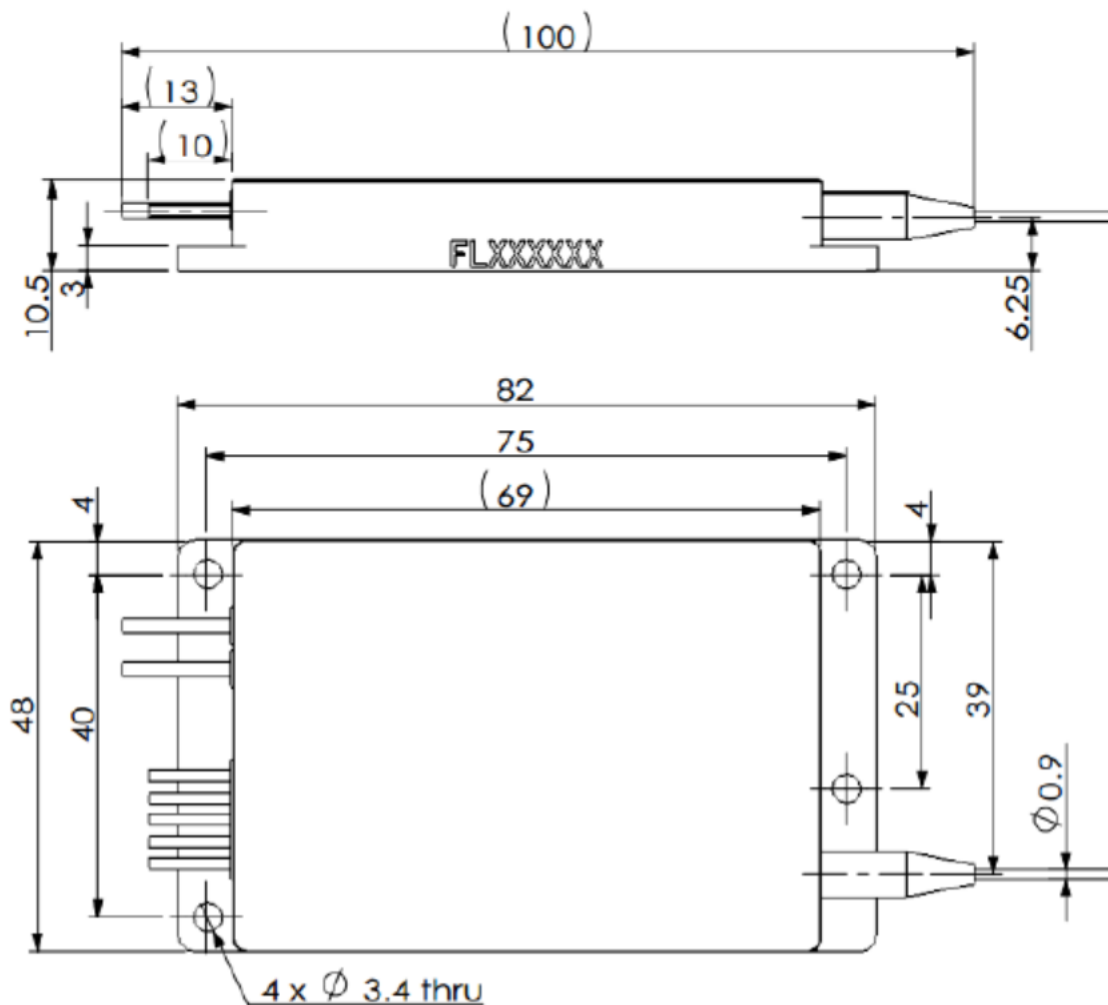

Remark: The structure drawing is for reference only. Please feel free to contact us for any special requirements.

Product Specifications

Product Code	FCE300003 ²		FCE000002		FCE300032 ²	
Part No. ¹	FL-E7-65-976-105		FL-E7-65-938-105		FL-E7-15-780-200	
Optical Data						
	Unit	Value				
CW/QCW-nominal output power	W	65	65	65	15	
Centroid wavelength	nm	976	938	938	780	
Wavelength tolerance (±)	nm	10	5	5	5	
Spectral width (FWHM)	nm	≤6	≤6	≤6	≤6	
Wavelength Temp. drift	nm/°C	~0.33	~0.33	~0.33	~0.28	
Wavelength stabilization		/	/	/	/	
Fiber connection						
Fiber included		Yes	Yes	Yes	Yes	
Fiber core diameter	μm	105	105	105	200	
Numerical aperture		0.22	0.22	0.22	0.22	
Fiber optic connector		SMA905	SMA905	SMA905	SMA905	
Fiber length	m	1.5±0.1	1.5±0.1	1.5±0.1	1.5±0.1	
Operation Conditions						
Nominal diode heat sink Temp.	°C	25	25	25	25	
Diode heat sink operation Temp. ³	°C	+20 ... +30	+20 ... +30	+20 ... +30	+20 ... +30	
Minimum heat sink capacity	W	130	130	130	75	
Electrical Data						
Max. operation current start of life	A	11.5	11.5	11.5	3	
Typical threshold current	A	0.7	0.7	0.7	0.8	
Typical operation voltage	V	14	14	14	14	
Typical slope	W/A	≥5.6	≥5.6	≥5.6	/	
Typical E/O efficiency	%	≥49	≥49	≥49	≥43	
Package						
Dimensions	mm ³	100×48×10.5	100×48×10.5	100×48×10.5	100×48×10.5	
Weight basic package	kg	0.16±0.05	0.16±0.05	0.16±0.05	0.16±0.05	
Storage Temp.	°C	-20 ... +80	-20 ... +80	-20 ... +80	-20 ... +80	
Additional Features						
Temp. sensors		NTC(10kΩ@25°C)	NTC(10kΩ@25°C)	NTC(10kΩ@25°C)	NTC(10kΩ@25°C)	
Monitor diode (driver: 9V)	mA	0.2 ... 1	0.2 ... 1	0.2 ... 1	0.2 ... 1	
Measurement						
Fiber		AR coated, 105μm	AR coated, 105μm	AR coated, 105μm	AR coated, 200μm	
Diode heat sink Temp.	°C	25	25	25	25	

¹ Part No. = Brand Code - Series - Power - Centroid Wavelength - Fiber core diameter.

² Typical customization of products.

³ Operation beyond recommended temperature may cause lifetime reduction or even damage to the product.

